



The TCCL is a heavy-duty, compact corner strip that is ideal for covers, showcases and other areas where low profile linear light sources are required

TCCL tiny channel | corner LED



Features and Specifications:

Construction:

- Durable steel body
- Snap-on frosted lens, injection molded end caps
- Wireway covers attach simply with screws for easy maintenance

Size Options:

- Available in 2', 3', 4', 6' and 8' lengths (nominal)

Listing & Ratings:

- All electrical components are U.L. listed or recognized
- All fixtures are U.L. Certified and Union made in the USA Meets
- Buy America Act (BAA), BABA Compliant

Mounting Options:

Surface mount

Driver:

- Universal voltage 120-277V standard
- Custom driver tuning for specific lumen requirements
- 0-10V or Lutron dimming optional

Warranty:

- 5 years - part replacement only (see our terms & conditions page at www.lamarled.com for details)

See page 2 for lumen chart & dimensions

Ordering Guide / Example		TCCL48M-40D		
TCCL				
Series	Size	Power	CCT	General Options
TCCL = Tiny channel corner led	24 = 2' nominal 36 = 3' nominal* 48 = 4' nominal 72 = 6' nominal 96 = 8' nominal	L = Low M = Medium H = High	80 CRI 30 = 3000K 35 = 3500K 40 = 4000K 50 = 5000K 90 CRI 930 = 3000K 935 = 3500K 940 = 4000K 950 = 5000K MCT = Field Selectable CCT 3000K, 3500K or 4000K (80 CRI)	EM = Emergency pack >90 min., >500 lumens (2ft not available) EMB = BABA Compliant Emergency pack >90 min., >500 lumens D = 0-10V dimming to 1% DTD = 0-10V Dim to Dark LDH = Lutron EcoSystem Hi-lume digital 1% w/Fade to Black MX1 or MX2 = 2-wire 120V or 277V 5% phase cut dimming

Consult factory for additional options not shown or listed Correlated Color Temperatures (CCTs) fall within the nominal range as per ANSI C78.377A

Project Information:		Certification & Listings:	
Job Name:	Fixture Type:		
Catalog #:	Date:		
Comments:			

BEFORE INSTALLATION, PLEASE CONSULT YOUR LOCAL ORDINANCES AND BUILDING CODES FOR COMPLIANCE

Dimensions

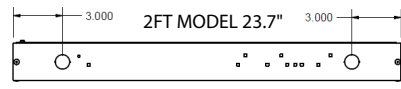

TOP VIEW

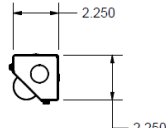

END VIEW

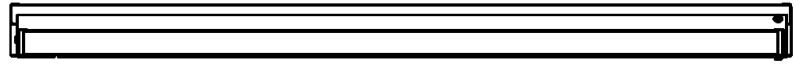
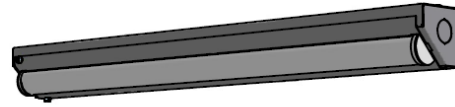

FRONT VIEW

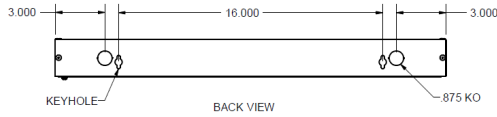

BACK VIEW

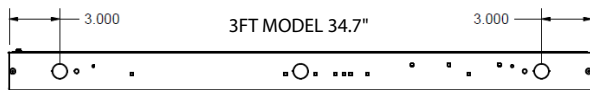

TOP VIEW

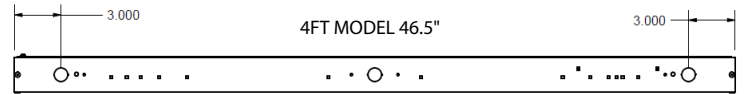

TOP VIEW

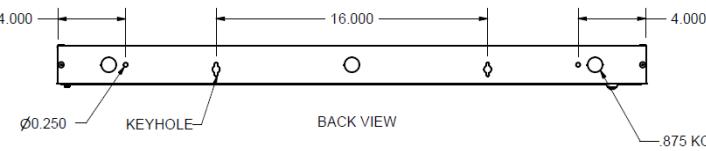

BACK VIEW

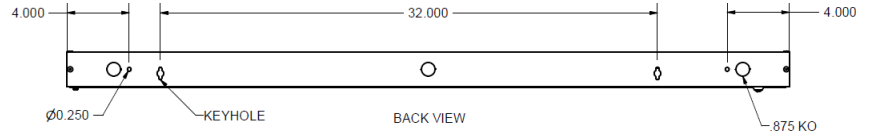

BACK VIEW

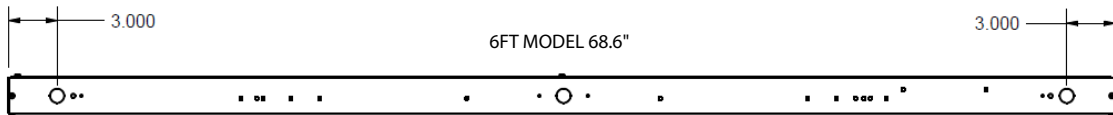

TOP VIEW

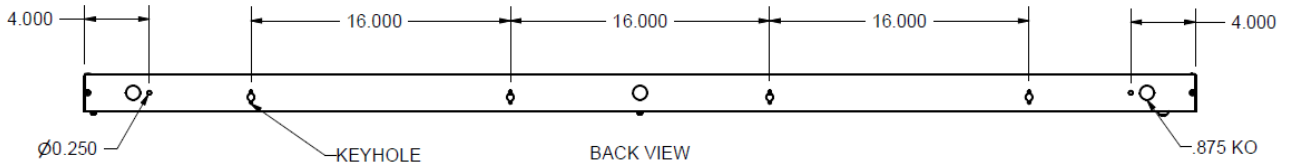

BACK VIEW

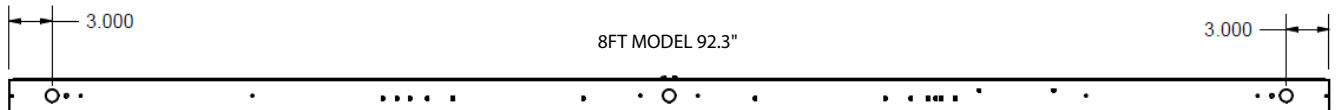

TOP VIEW

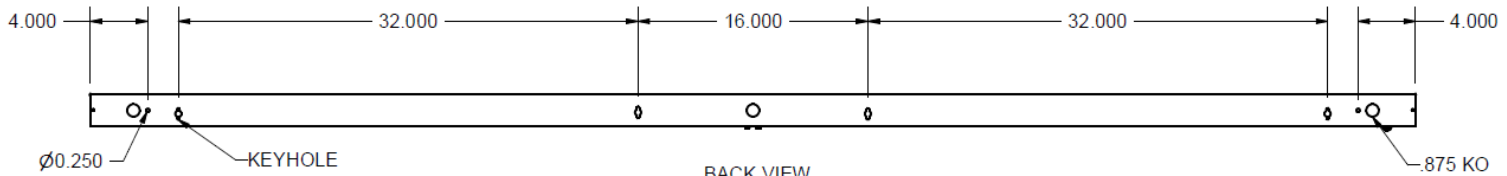

BACK VIEW

Lumen/Wattage Chart - 4000K

4000K	Low	Med	High
4'	2309	4041	5867
	19W	33W	51W
8'	4618	8082	11,734
	38W	66W	102W

CCT	Lumen Multiplier
3000K	95.0%
3500K	96.0%
4000K	100.0%
5000K	101.0%

LAMAR LED assumes no responsibility for misapplication of fixtures
 Due to the rapid advancements in LED technology, please consult our website for the most current technical data.

Specifications subject to change without notice - Rev 1225